

# NND-SERIES

Linear power supply dual output 15W ~ 30W

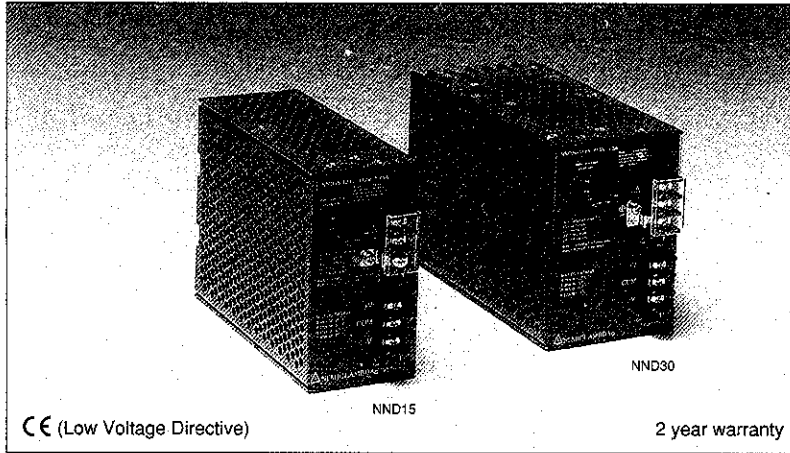

CE (Low Voltage Directive)

NND15

NND30

2 year warranty

## Model name NND 15-1212

Name of series Output power: 15W, 30W  
Combination of output voltages 1212:  $\pm 12\text{VDC}$   
1515:  $\pm 15\text{VDC}$

### Features

- CE marking (Low Voltage Directive)
- Compact linear power supply  
Low ripple & noise: 1mV (rms), 3mV (pk-pk)
- Low leakage current: 50 $\mu\text{A}$
- Wide operating temperature range:  $-20 \sim +71^\circ\text{C}$
- Input voltage range  
100/115/200/230VAC
- 2 year warranty

### Specifications

1. Input voltage range	100VAC: 85 ~ 115VAC 115VAC: 98 ~ 132VAC 200VAC: 170 ~ 230VAC 230VAC: 195 ~ 265VAC selectable
2. Output voltage range	$\pm 10\%$ (for each output)
3. Line regulation	Line regulation: 0.01% (Within input voltage range at constant load)
4. Load regulation	Load regulation: 0.03% (No load to full load at constant input voltage)
5. Maximum ripple & noise	1mV (rms) 3mV (pk-pk)
6. Cooling	Convection cooling
7. Operating ambient temperature (Standard mounting)	$-20 \sim +71^\circ\text{C}$ $-20^\circ\text{C}$ : 60%, $0 \sim +50^\circ\text{C}$ : 100%, $+60^\circ\text{C}$ : 60%, $+71^\circ\text{C}$ : 40%
8. Withstand voltage	Input-output: 3.75kVAC, Input-FG: 2.5kVAC
9. Safety standard	Approved by UL1950 , CSA950  and EN60950
10. EMI	Conforms to VCCI-class, FCC class B and VDE class B
11. Functions	Over voltage protection, Over current protection

### Product lineup

Model name	CH	Nominal output voltage	Max. output current	Max. output power	UL	CSA	EN
NND15	NND15-1212	CH1	+12V	0.75A	18W	○	○
		CH2	-12V	0.75A			
	NND15-1515	CH1	+15V	0.6A	18W	○	○
		CH2	-15V	0.6A			
NND30	NND30-1212	CH1	+12V	1.6A	38.4W	○	○
		CH2	-12V	1.6A			
	NND30-1515	CH1	+15V	1.3A	39W	○	○
		CH2	-15V	1.3A			

- Request customer specification for further details of specifications, outline, characteristics, etc.  
Read the instruction manual before usage.
- Contact us about delivery before ordering.

○ : Safety standard approved  
△ : Conforms to safety standard

# NND-SERIES

Unit Type Power Supply

## ■ NND15

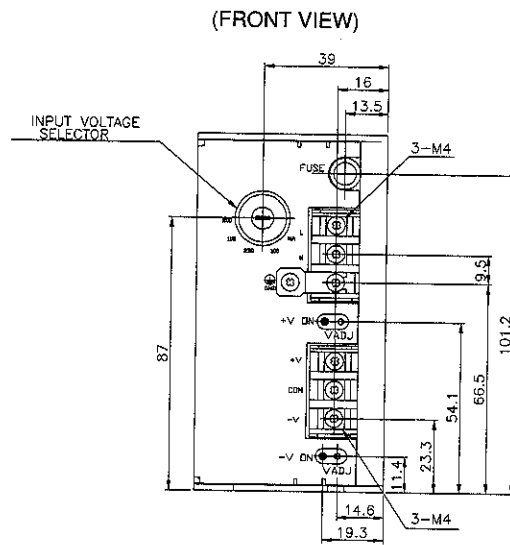
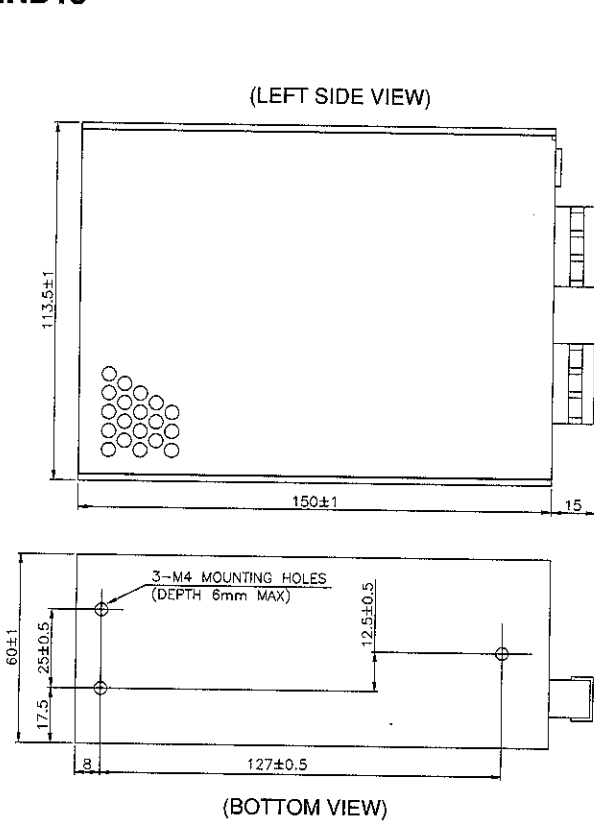

(Unit: mm)

## ■ NND30

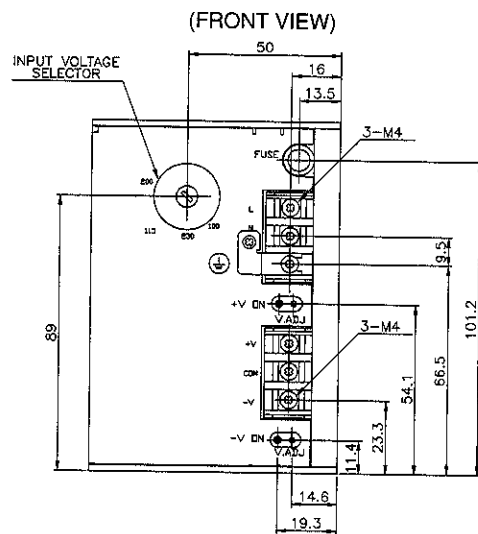
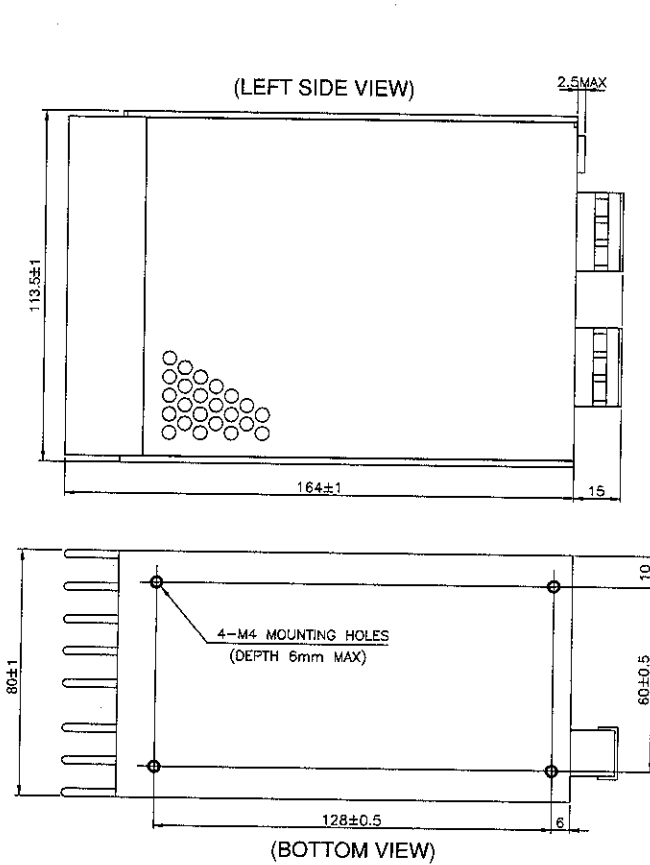

(Unit: mm)